

Innovation by Rethinking Known Process

- Coherence, Collaboration and Public/Private Entanglement

Brian Holch Kristensen

Head of Innovation

Bispebjerg and Frederiksberg Hospital

The Arena – danish built hospitals

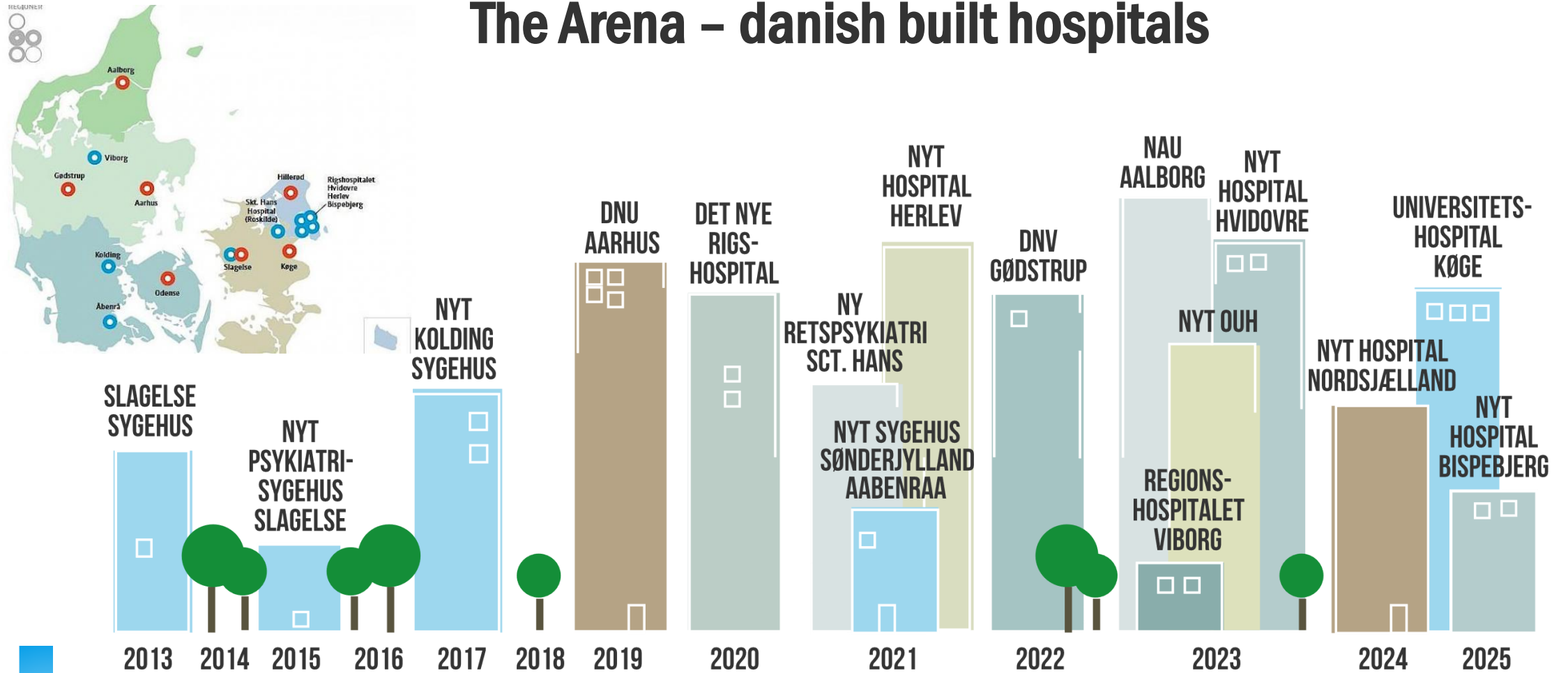

The Arena – New Bispebjerg Hospital



Political Demands and the Translation into the Build



Focus on the patient

Single room ward only

Realtime documentation with the patient

Efficiency

Optimized waiting area capacity

Internal hospital logistics and supply

Flexibility

Standardization of facilities and rooms

Common clinical areas

Technologies to aid the builds and visions #1

Intelligent surveillance of patients and activities in a ward

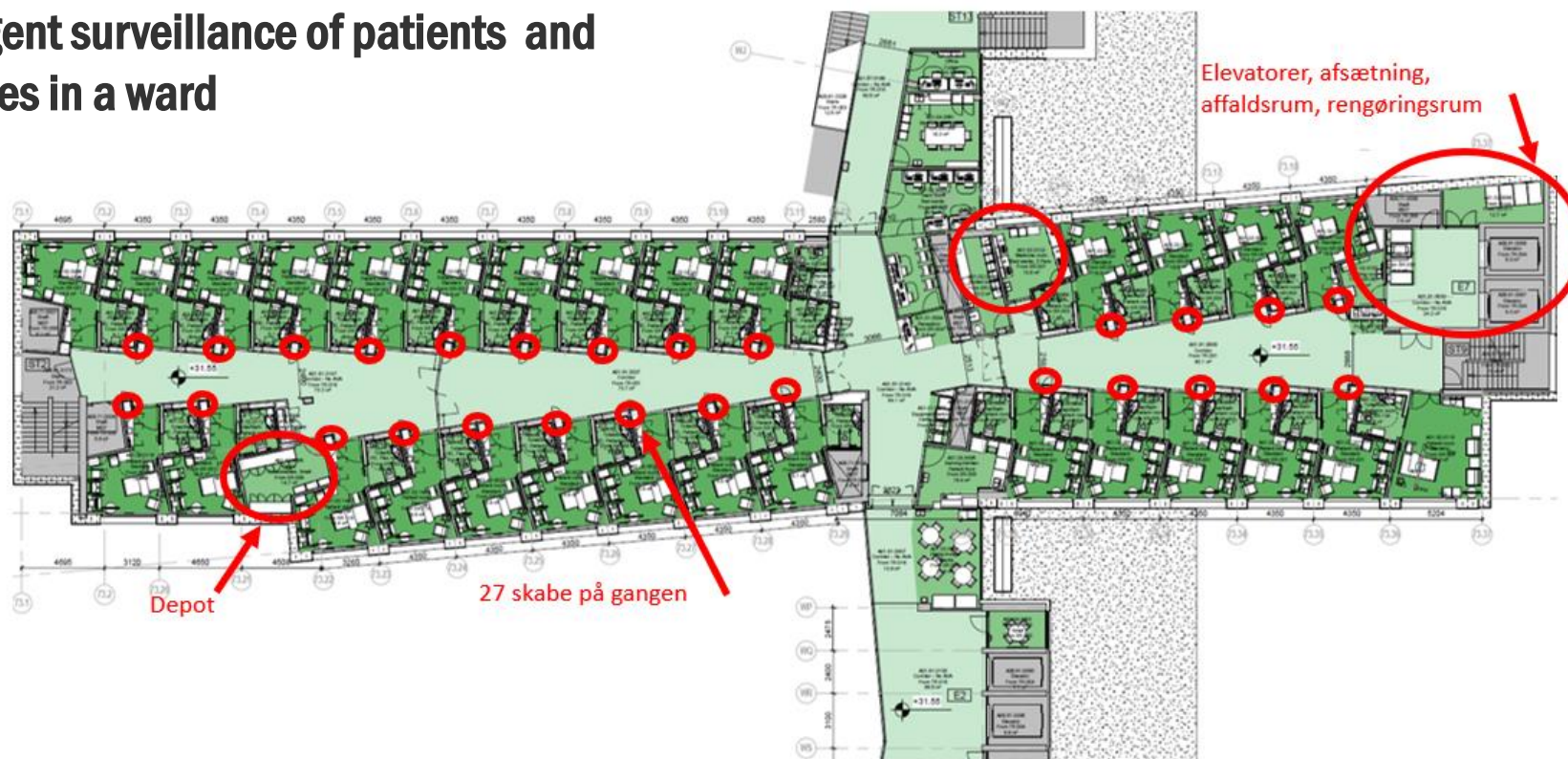

Technologies to aid the builds and visions #2

Patient involvement
Patient Terminals
Mobile Devices
In-Room Screens



Technologies to aid the builds and visions #3

Wayfinding

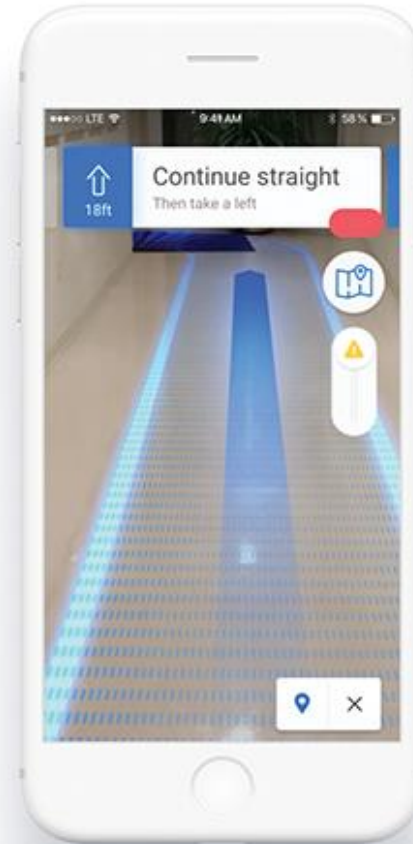

Technologies to aid the builds and visions #4

Logistics
Just in Time



New ways of collaboration to meet the needs

Innovation partnerships

- Tender the problems not the solutions
- Formalised co-creation

Coherence in a ward

- Healthcare personnel
- Patients

Exploit the single room facility

- Patient/next of kin involvement

Embrace the patient journey

Just in Time logistics